





∅ 32 | Massima forza, tenuta stelo - Maximum force, rod sealed - Maximale Kraft, Kolbenstange dichtung
 Forces maximale, joint de tige - Máxima fuerza, estanqueidad vástago - Força máxima, estanquidade na haste

SEALING	ROD SEAL
DESIGN	BOTTOM BASE - BODY DESIGN

1	Retaining ring	5	Valve	9	Back-up ring
2	Dual ring seal	6	Body	10	Rod wiper
3	Bottom base	7	Guide ring	11	Rod (nitrited superfinished)
4	Plug	8	Rod seal		

RANGE CHART

Model	Body Ø		Stroke Cu		Initial force F0		 OSAS	 USAS	 OPAS	 SKUDO
	mm	inch	mm	inch	daN	lb				
MQ 700	32	1.26	10 - 80	0.39 - 3.15	660	1484	✓	✓	-	-

HOW TO ORDER

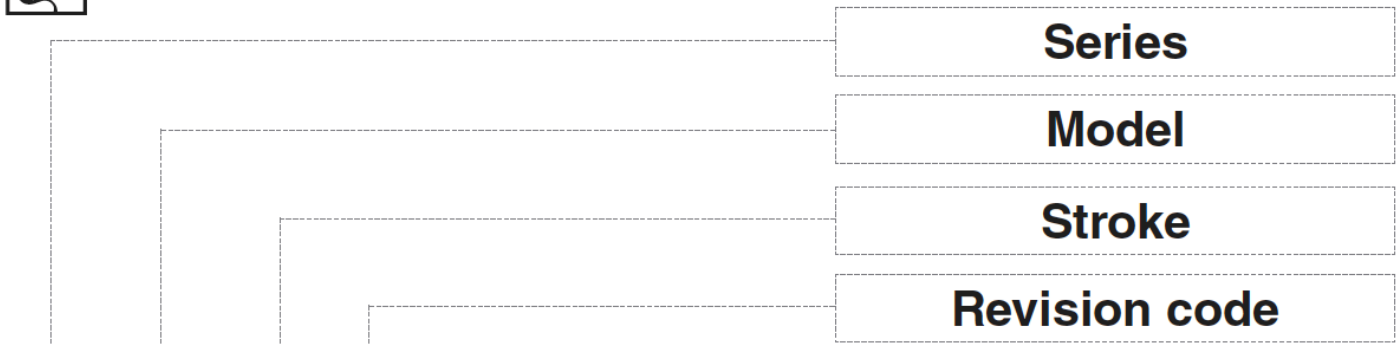

MQ 700-050-A

- IT** Codice cilindro autonomo
- EN** Self-contained cylinder code
- DE** Kode des eingeständigen Gdf.
- FR** Code du cylindre autonome
- ES** Código del cilindro autónomo
- PT** Código do cilindro autónomo

ACTIVE SAFETY



OSAS



USAS

* $F_{1i} =$

Isothermal
end force
at 100% Cu



p. 16



** $F_{1p} =$

Polytropic
end force
at 100% Cu

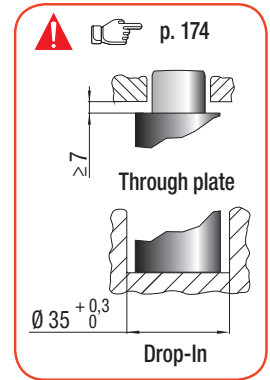
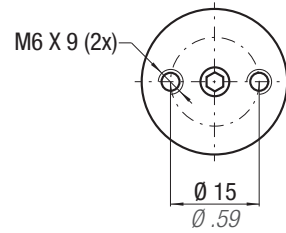
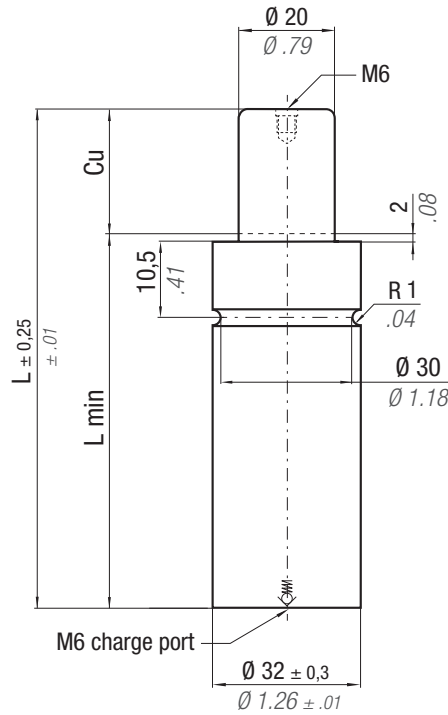

CODE	N ₂	°F 32 - 176	°C 0 - 80	ΔP ± 0,33 %/°C	P max 210 bar 3045 psi	P min 20 bar 290 psi	S 3,14 cm ² 0.487 in ²	SPM ~ 40 - 80 (at 20°C)	Max Speed 1,6 m/s	Maintenance kit 39BMMP02000A	Vo		PED		
											cm ³	in ³	~Kg	~lb	2014/68/EU
MQ 700 - 010 - A											12,0	0,73	0,29	0,64	✓
MQ 700 - 015 - A											15,0	0,92	0,31	0,68	✓
MQ 700 - 020 - A											18,0	1,10	0,33	0,73	✓
MQ 700 - 025 - A											21,0	1,28	0,35	0,77	✓
MQ 700 - 032 - A											26,0	1,59	0,38	0,84	✓
MQ 700 - 038 - A											32,0	1,95	0,41	0,90	✓
MQ 700 - 045 - A											36,0	2,20	0,44	0,97	✓
MQ 700 - 050 - A											39,0	2,38	0,46	1,01	✓
MQ 700 - 056 - A											45,0	2,75	0,49	1,08	✓
MQ 700 - 063 - A											52,0	3,17	0,53	1,17	✓
MQ 700 - 080 - A											63,0	3,84	0,60	1,32	✓

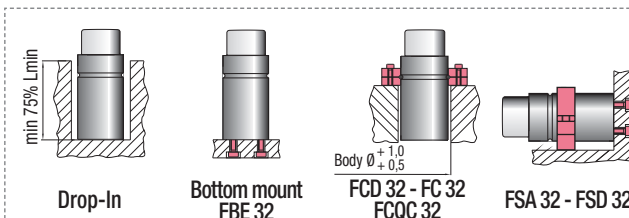

HOW TO ORDER

(10 pcs) MQ 700-050-A